

VMVEI100 extraction/intake air valve



FEATURES

Extraction/intake air valve for rigid or flexible ducts Ø100 mm, with aerodynamic throttling disc, manually adjustable.

Material and color

Impact-resistant plastic material (Karbamid and Propen), white RAL 9002, with smooth surface; resistant up to temperature of 100°C.

Use

HRV / Air Conditioning systems for residential buildings.

Manual adjustment

By screwing and unscrewing the central disc.

Special features

Equipped with Moltopren gasket that prevents the deposit of vent dust on the walls or ceiling.

Connection diameter: Ø100 mm.

Fixing method

Wall- or ceiling-mounted directly in the duct (with safety springs for fixing on the duct).

DIMENSIONAL

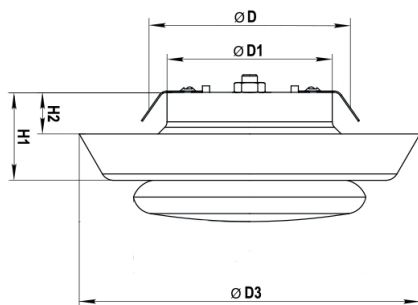

Code	ØD [mm]	ØD1 [mm]	ØD3 [mm]	H1 [mm]	H2 [mm]	Adjustment turns [0-max]
VMVEI100	100	84	148	44	26	0...20

TABLE OF THE DISK ADJUSTMENT

Code	Nominal valve Ø	Opening degree [number of turns]	Air flow rate	60	80	100	120
				[m³/h]	[m³/h]	[m³/h]	[m³/h]
VMVEI100	Ø 100	6	Pressure drop (Pa)	90	-	-	-
			Pot level. sound (dBA)	35	-	-	-
		12	Pressure drop (Pa)	23	28	58	-
			Pot level. sound (dBA)	25	25-30	35	-
		20 (max apert.)	Pressure drop (Pa)		11	19	31
			Pot level. sound (dBA)		<20	<25	25-30